

HSF

NOTES:
 Rated Current: 7.0AMP
 Contact Resistance: 20mΩ max
 Withstand Voltage: 1000V AC/DC
 Insulation Resistance: 1000MΩ min
 Operation Temperature: -40°C to +85°C

Contact Material: Brass
 Contact plating: Au Or Sn Over Ni
 Insulator Material: PA66 UL94V-0

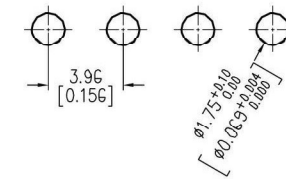
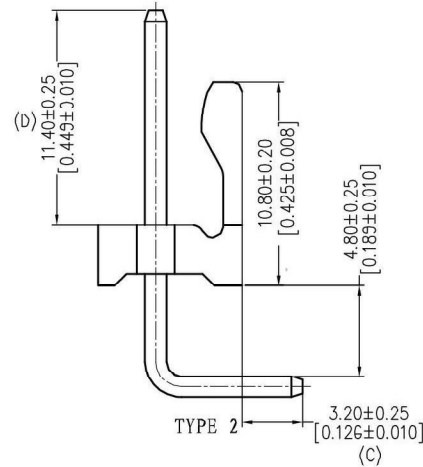
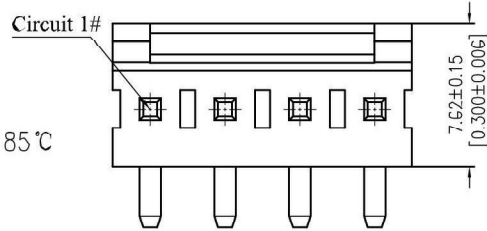

Recommended P.C.B Layout (Top Side)
 (PCB BOARD TOLERANCE ±0.05)

Ordering Information

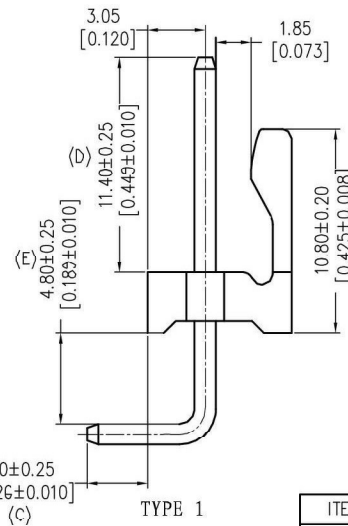
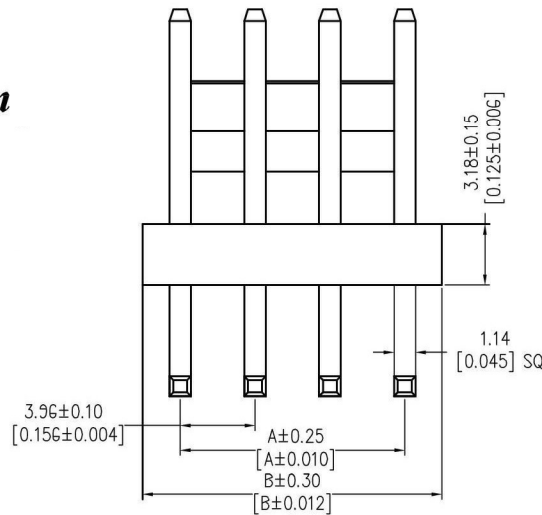
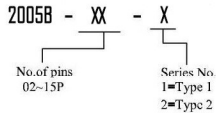

Circuit	Part No.	Dimension	
		A	B
02	20058-02-X	3.96	7.92
03	20058-03-X	7.92	11.88
04	20058-04-X	11.88	15.84
05	20058-05-X	15.84	19.80
06	20058-06-X	19.80	23.76
07	20058-07-X	23.76	27.72
08	20058-08-X	27.72	31.68
09	20058-09-X	31.68	35.64
10	20058-10-X	35.64	39.60
11	20058-11-X	39.60	43.56
12	20058-12-X	43.56	47.52
13	20058-13-X	47.52	51.48
14	20058-14-X	51.48	55.44
15	20058-15-X	55.44	59.40
16	20058-16-X	59.40	63.36
17	20058-17-X	63.36	67.32
18	20058-18-X	67.32	71.28
19	20058-19-X	71.28	75.24
20	20058-20-X	75.24	79.20

ITEM	C	D	E
Standard	3.20	11.40	4.80
Alternate			

REV	DATE	MODIFICATION DESCRIPTION	CHANGE	OPERATION	DRAW	DATE	SCALE	FIT	PART NO.
				X.X ±0.40	CHECK	DATE	UNIT	mm	SEE TAB
				X.XX ±0.25			in		
				X.XXX ±0.15			SIZE	A4	
				Angle ± 3'	APPROVE	DATE	SHEET	1/1	TITLE: VH 3.96 WAFER 90° DIP (SQUARE PIN)
				DIM TOL			PROJ.	Customer NO.	

Ho Chien
 www.hochien.com