

1 2 3 4 5 6 7 8

F
E
D
C
B
A

F
E
D
C
B
A

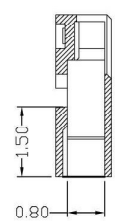
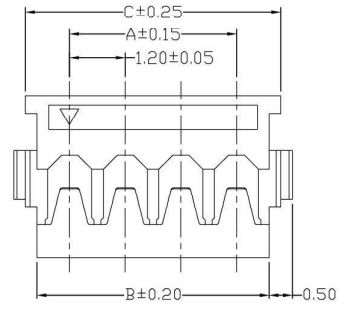
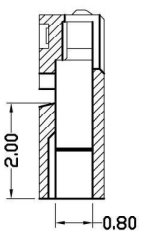
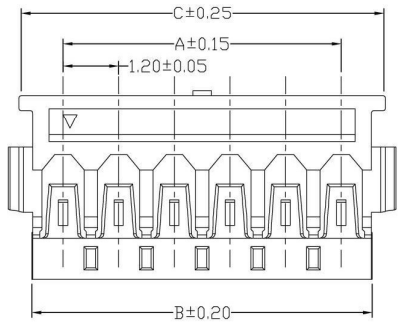

- Specifications
- Voltage rating : 50V AC / DC
 - Current rating : 2A AC / DC
 - Withstanding voltage : 500V AC/minute
 - Temperature range : -25°C~+85°C
 - Insulation resistance : ≥100MΩ
 - Contact resistance : ≤20mΩ
 - After environmental testing : ≤30mΩ

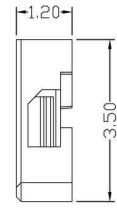
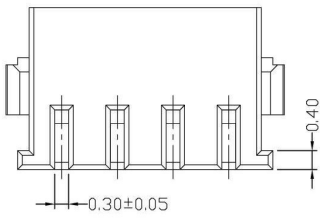
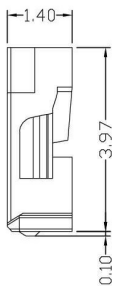
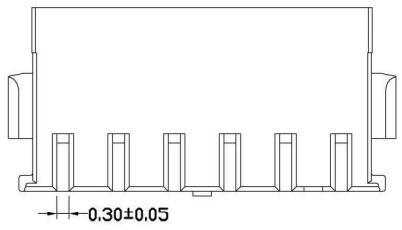
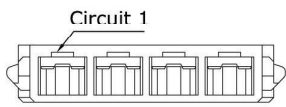
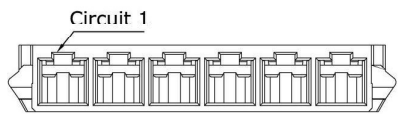

Poles	Dimensions(mm)		
	A	B	C
2	1.20	2.60	3.10
3	2.40	3.80	4.30
4	3.60	5.00	5.50
5	4.80	6.20	6.70
6	6.00	7.40	7.90
7	7.20	8.60	9.10
8	8.40	9.80	10.30
9	9.60	11.00	11.50
10	10.80	12.20	12.70
11	12.00	13.40	13.90
12	13.20	14.60	15.10
13	14.40	15.80	16.30
14	15.60	17.00	17.50
15	16.80	18.20	18.70

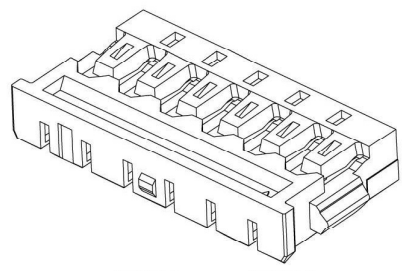

6PIN 6PIN

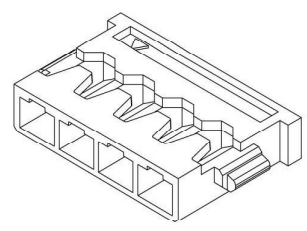

2PIN-5PIN

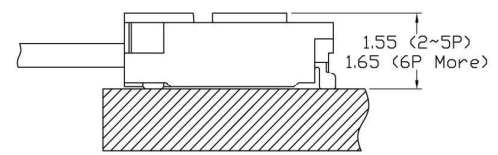

MATING VIEW

					<p>GENERAL TOLERANCE</p> <p>. X ±0.3</p> <p>. XX ±0.2</p> <p>. XXX ±0.1</p>				<p>Ho Chien</p> <p>www.hochien.com</p>				<p>PART NO 1224H-04</p>											
					<p>APPD</p>				<p>CHK</p>				<p>DR</p>				<p>DATA</p>							
					<p>PROJECT</p>				<p>UNIT</p>				<p>SCALE</p>				<p>NUMBER</p>				<p>REV</p>			
DATE	OLD REV	NEW REV	DESCRIPTION		CHK	APPD	PROJECT		UNIT	SCALE	NUMBER	REV	UNIT		SCALE	NUMBER	REV	UNIT		SCALE	NUMBER	REV		
1			2	3	4	5	6	7	8	9	10	11	12	13	14	15	16	17	18	19	20	21		

1 2 3 4 5 6 7 8