

PCB LAYOUT

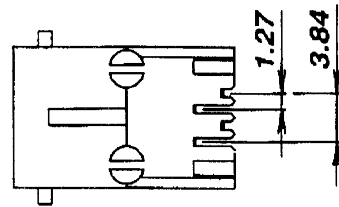

SPECIFICATION :

1. Electrical Char.

- Insulation Resistance : 500M-Ohm Min.
- Contact Resistance : 20milli-Ohm Max.
- Rating Current : 1.5A Max.
- Rating Voltage : 120V AC
- Dielectric Voltage : 1,000 RMS 60 Sec. Min.

2. Physical Char.

- Housing : PBT 20% Glass Filled (UL 94V-0)
- Color : Black Color
- Spring Wire : 0.35mm Thickness Phosphor Bronze
- Gold Plating Over Nickel
- Temperature Range : - 25 +90 C
- Durability : 500 Mating cycles Min.

HC-006-4 -A -X

A=4p4c

Gold plated	1=15u, 3=50u 2=30u, 4= 6 u
-------------	-------------------------------

HO CHIEN
www.hochien.com

TITLE
RJ11 SIDE ENTRY PCB JACK
UL & cUL FILE NO. E131820

MODULAR JACKS ASSY FOR
HC-006-4-A-X

SCALE SIZE DWG. NO. 9601 SERIES

DWG. NO.
AS006001

DO NOT SECALE DRAWING	TOLERANCES UNLESS OTHERWISE NOTED	INCH	MM	DR.	DATA
 THIRD ANGLE PROJECTION	LINEAR $\frac{MM}{INCH}$	00±0.1	00±0.25	Steven	MAR-31 '03
		000±0.05	000±0.13	Johnn	MAR-31 '03
		0000±0.02	0000±0.05	Billy	MAR-31 '03
MM INCH	ANGLE +0°30'	RADIL	+0.45 -0.15	APP'D	