

P.C.BOARD

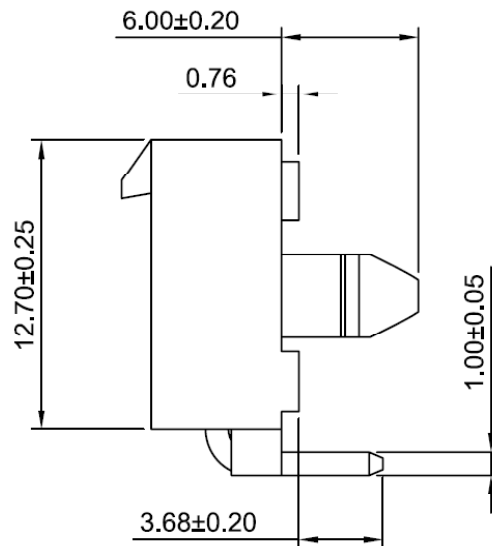
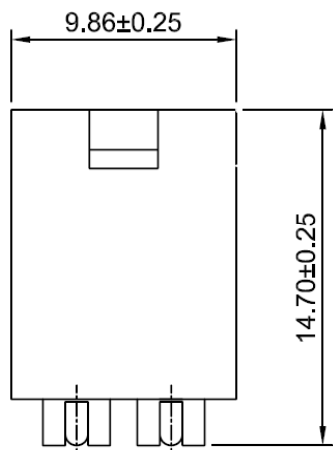

SPECIFICATIONS:

Current Rating: 9.5A AC,DC
 Voltage Rating: 600V AC,DC
 Temperature Range: -40°C ~ +105°C
 Contact Resistance: 10mΩ Max
 Insulation Resistance: 1000MΩ Min
 Withstanding Voltage: 1500V AC/minute
 Pin Material: Brass/Tin-plated
 Material: Nylon 66,UL94V-0

HO CHIEN
 www.hochien.com

Unit	Scale	Sheet
mm	1:1	1 of 1
Draw BY:	Approved :	
LIZQ	GONGYB	
General Tolerance		
x.x≤0.25	ANGLE±	
x.xx≤0.20	⊕	
x.xxx≤0.15		

Title :
 4.14mm PITCH
 90° WAFER

DRAW NO : 4140WR-2P

REV
 A0

AO	NEW RELEEASE	2011.02.24
REV	DESCRIPTION	DATE